

## HIPPO Bond Unsanded Polymer Grout

HIPPO Bond Unsanded Polymer Grout is a water-resistant cement based tile joint filler developed to provide long-lasting, water-resistant joints in wall and floor tiles. It levels easily, sets hard, and creates a clean, dust-free surface.



### AREAS OF APPLICATION

Suitable for bathrooms, kitchens, and both internal and external tiled surfaces. Best for joints up to 5 mm width.

### FEATURES

- High compressive, tensile & flexural strength
- Water-resistant finish
- Easy application and maintenance
- Available in 10 attractive shades

### BENEFITS



Water-resistant tile joints



Easy to clean



Durable and strong finish

### HOW TO USE



1 Mix 3 to 3.5 parts HIPPO Unsanded Tile Grout with 1 part water by volume to achieve a smooth paste



2 Apply using a rubber trowel

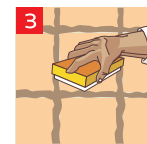

3 Remove excess grout with a damp sponge



4 Let the surface cure for at least 24 hours

#### HIPPO BOND INDUSTRIES LLP

Mail id: info@hippobond.com  
Contact No: 9726554000  
Address: HIPPO BOND INDUSTRIES LLP,  
Shop No. 6, Silver Pearl, B/h. Ganesh Meridan,  
Opp. Kargil Petrol Pump, Ghatlodia,  
Ahmedabad, Gujarat, 380061.

#### DISCLAIMER

The product information provided is intended as a general guideline. We recommend testing for suitability before full-scale use. HIPPO Industries Pvt Ltd is not liable for outcomes resulting from incorrect use, surface conditions, or third-party materials.



# HIPPO BOND

## HIPOXY GROUT

HP-100



Color make  
Dreams come true!

## HIPPO BOND HIPOXY GROUT HP-100

HIPPO Bond Hipoxy Grout is a premium-grade epoxy grout designed to deliver a clean, seamless finish for tile joints. Built to resist stains, water, and chemicals, it's ideal for high-moisture environments like kitchens and bathrooms.

### AREAS OF APPLICATION

Perfect for tiled areas prone to moisture - including wet zones between tiles, stones and other surfaces, particularly in areas with high moisture or chemical exposure

### FEATURES

- Smooth, easy-to-mix formulation
- Simple cleanup with a damp sponge
- Reinforces tile joints while preserving aesthetics
- Comes in a vibrant, durable shade range

### BENEFITS



Crack-free joints



Strong resistance to stains & acids



Long-lasting water protection



1 Combine resin and hardener as instructed



2 Gradually add filler and mix until smooth

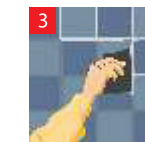

3 Apply into joints using a rubber float



4 Wipe off excess with a damp sponge within 30 minutes

Cementitious Tile Grout Coverage in sq.ft/kg										
Tile Dimension (mm)			Joint/Grouting Width							
Length	Width	Thickness	2	3	4	5	6	8	10	12
300	200	6	77.7	51.8	38.9	31.1	25.9	19.4	15.5	13.0
300	300	6	97.1	64.8	48.6	38.9	32.4	24.3	19.4	16.2
450	300	6	116.6	77.7	58.3	46.6	38.9	29.1	23.3	19.4
600	300	6	129.5	86.3	64.8	51.8	43.2	32.4	25.9	21.6
600	600	8	145.7	97.1	72.9	58.3	48.6	36.4	29.1	24.3
800	800	8	194.3	129.5	97.1	77.7	64.8	48.6	38.9	32.4
1000	1000	10	194.3	129.5	97.1	77.7	64.8	48.6	38.9	32.4
1200	600	10	155.4	103.6	77.7	62.2	51.8	38.9	31.1	25.9
1200	800	10	186.5	124.3	93.3	74.6	62.2	46.6	37.3	31.1
1200	1200	12	194.3	129.5	97.1	77.7	64.8	48.6	38.9	32.4
1600	800	12	172.7	115.1	86.3	69.1	57.6	43.2	34.5	28.8
1800	1200	12	233.1	155.4	116.6	93.3	77.7	58.3	46.6	38.9
25	25	6	8.1	5.4	4.0	3.2	2.7	2.0	1.6	1.3
25	50	6	10.8	7.2	5.4	4.3	3.6	2.7	2.2	1.8
50	50	6	16.2	10.8	8.1	6.5	5.4	4.0	3.2	2.7
100	100	6	32.4	21.6	16.2	13.0	10.8	8.1	6.5	5.4
100	100	10	19.4	13.0	9.7	7.8	6.5	4.9	3.9	3.2

Epoxy Tile Grout Coverage in sq.ft/kg										
Tile Dimension (mm)			Joint/Grouting Width							
Length	Width	Thickness	2	3	4	5	6	8	10	12
300	200	6	59.8	39.9	29.9	23.9	19.9	14.9	12.0	10.0
300	300	6	74.7	49.8	37.4	29.9	24.9	18.7	14.9	12.5
450	300	6	89.7	59.8	44.8	35.9	29.9	22.4	17.9	14.9
600	300	6	99.6	66.4	49.8	39.9	33.2	24.9	19.9	16.6
600	600	8	112.1	74.7	56.0	44.8	37.4	28.0	22.4	18.7
800	800	8	149.4	99.6	74.7	59.8	49.8	37.4	29.9	24.9
1000	1000	10	149.4	99.6	74.7	59.8	49.8	37.4	29.9	24.9
1200	600	10	119.6	79.7	59.8	47.8	39.9	29.9	23.9	19.9
1200	800	10	143.5	95.6	71.7	57.4	47.8	35.9	28.7	23.9
1200	1200	12	149.4	99.6	74.7	59.8	49.8	37.4	29.9	24.9
1600	800	12	132.8	88.6	66.4	53.1	44.3	33.2	26.6	22.1
1800	1200	12	179.3	119.6	89.7	71.7	59.8	44.8	35.9	29.9
25	25	6	6.2	4.2	3.1	2.5	2.1	1.6	1.2	1.0
25	50	6	8.3	5.5	4.2	3.3	2.8	2.1	1.7	1.4
50	50	6	12.5	8.3	6.2	5.0	4.2	3.1	2.5	2.1
100	100	6	24.9	16.6	12.5	10.0	8.3	6.2	5.0	4.2
100	100	10	14.9	10.0	7.5	6.0	5.0	3.7	3.0	2.5

### H-11 UNSANDED POLYMER GROUT



### HP-100 HIPOXY GROUT

